

# School of English Language 2018

*For New Zealand  
permanent residents*





# Kia ora, welcome to Ara

It is my pleasure as CEO to introduce you to an exciting range of education solutions that Ara has created to challenge minds and promote passionate learning. Our dedication and commitment to being the best in all that we do has kept Ara at the forefront of applied, vocational learning globally.

Nurturing great thinkers requires individual attention. We pride ourselves on having classes that ensure a personal learning experience. We are in the business of shaping lives, creating leaders and cultivating social pioneers; we look forward to sharing our wealth of knowledge and experience with you.

**Tony Gray**  
**Ara Chief Executive**

## About Ara

### Our new identity

CPIT and Aoraki Polytechnic have formed a new organisation, Ara Institute of Canterbury, to provide vocational and applied tertiary education in the Canterbury region of New Zealand.

At Ara we believe in a personalised learning experience; one that is flexible and respectful of our students' educational needs and career goals. We help you to excel with your studies and make the most of the time you spend living in New Zealand.

You will enjoy classes with a high staff-to-student ratio and easy access to our impressive purpose-built facilities. Our focus is always on balancing theory with practical learning to ensure you're work-ready when you graduate.

### Key facts



Established 1906



New Zealand **government-owned** NZQA **Category 1** Institution



Annual student numbers including 1,800 international students per year



Classes from 16 - 100 students



Minimum age **17**; no maximum age



Lecture time



Self study time



Approved provider for **pathway visas** under the Immigration New Zealand pilot programme



Signatory to the New Zealand **Code of Practice** for the Pastoral Care of International Students

### Ara is a member of:



# Why choose Ara Institute of Canterbury?

Ara is one of the largest institutes of technology in New Zealand with five sites and a choice of more than 150 qualifications including degrees and graduate diplomas. At Ara we specialise in education for employment; when you study with us you'll gain skills, knowledge and practical experience, and you'll graduate work-ready with a globally recognised qualification.



Our tutors have years of professional experience and extensive industry connections. Most of our programmes include work-integrated learning (up to 1400 hours for some qualifications) and our course completion rate is among the highest in New Zealand.

Our classes are small so you'll get to know your tutors and classmates well. Our staff are committed to your success and we offer a comprehensive range of accessible student support services including international student advisors who speak several languages.

Wherever in the world you come from, you will be welcomed into our inclusive community made up of staff and students from more than 50 countries. You'll also have many opportunities to enjoy free time in a safe, friendly region close to beautiful scenery and adventure pursuits.

## More than 150 qualifications

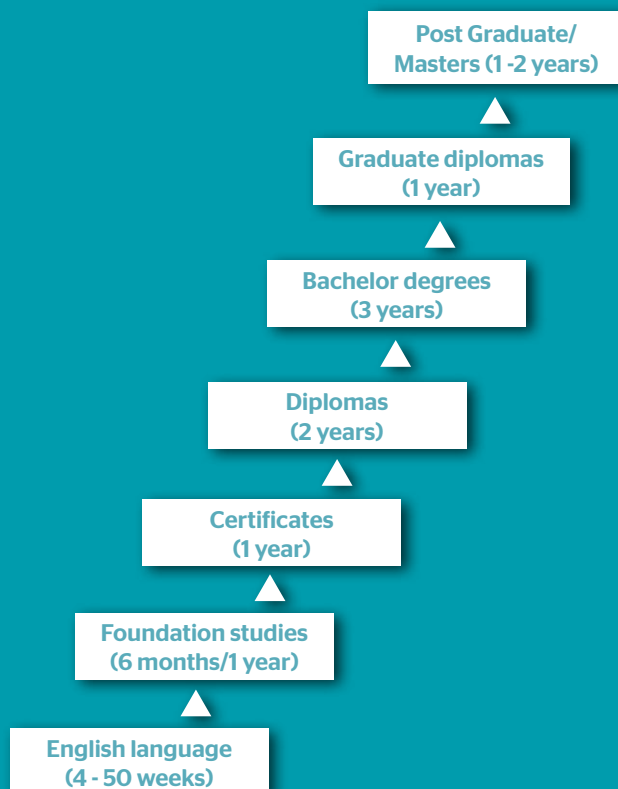

## Authorised English Examination Centre

Ara is an approved examination centre for IELTS and Cambridge examinations and awards. Our examinations coordinator can assist with registration.



# Why choose Christchurch's City campus?



## City campus

- It's conveniently located in the city centre
- It has state-of-the-art facilities including a new engineering and architectural studies building and a new recreation centre and training gym
- You can follow a seamless study pathway from English through to Master's degrees
- You'll learn in a vibrant environment with more than 50 different nationalities on campus
- There are many events and activities organised for City campus students

Our largest campus, located in Christchurch, is here:

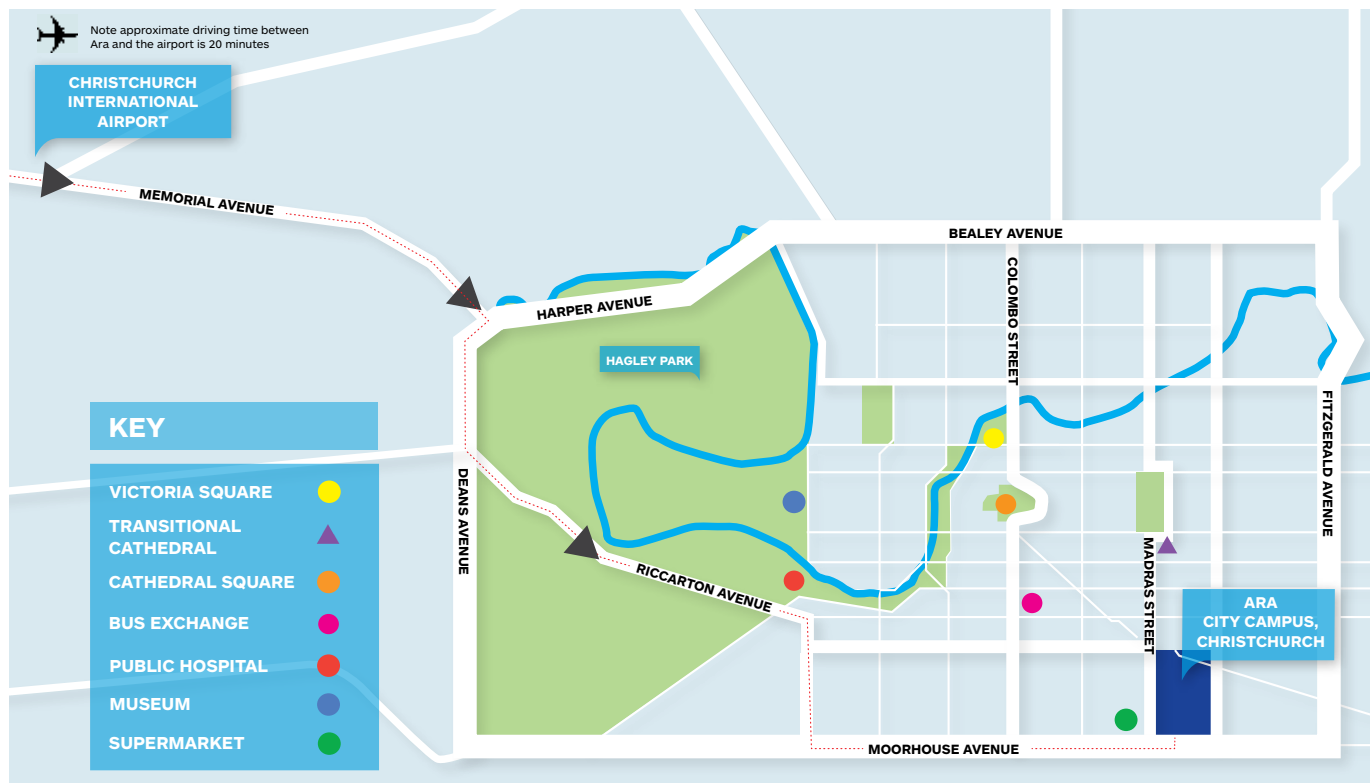

## Facilities and services for international students

A wide range of facilities and services are available to you as an international student. These include:

- bilingual student advisors
- language self-access centres
- digital language laboratories
- computer labs with the latest language learning technology
- libraries
- study groups
- recreation and health centres
- careers centre
- on-campus cafés

Beyond study, there are many events, activities and clubs you can participate in.



## Student Support

Achieving your goals and experiencing the essence of student life can be both exciting and challenging. Our support services are devoted to helping you enjoy all the benefits of being a student.

Our support services staff can help you with everything from enrolment to accommodation advice, through to learning support and choosing your career. You'll also find plenty of opportunities to socialise with several cafés and outstanding recreation facilities on campus.



City Campus Library



Student Recreation Centre



Otautahi House - Student Accommodation Christchurch

# Why choose to study in Timaru?



## Timaru campus

- Timaru offers a beautiful location close to mountains, lakes, the sea and exciting outdoor activities
- Our Timaru campus is an approved provider for pathway visas
- It's a great environment for English language study; with fewer international students you can fully immerse yourself in the English language
- Our classes are small so you receive more personal attention from tutors
- We specialise in programmes that prepare students for work

## Timaru campus

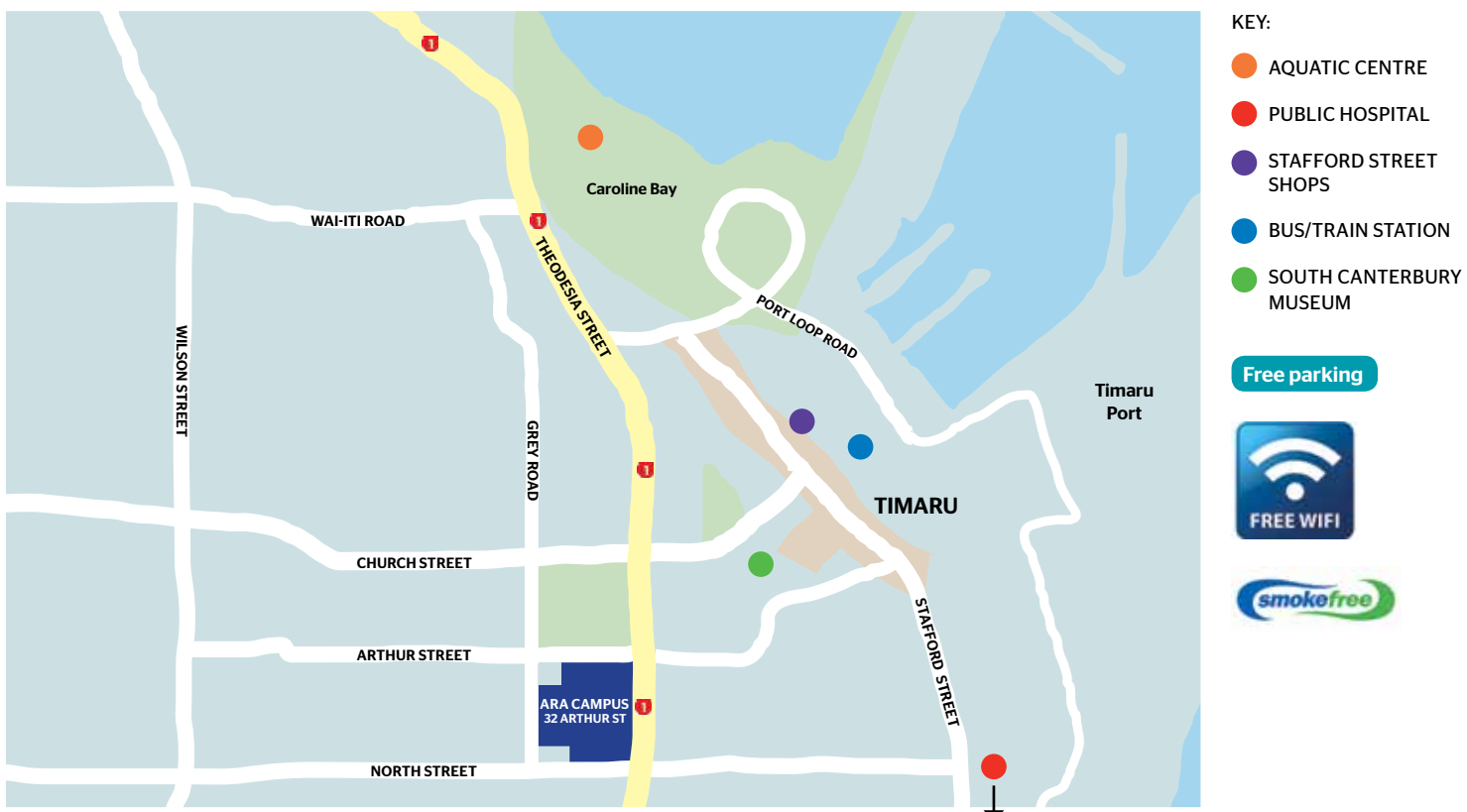

## Activities & Attractions around South Canterbury

South Canterbury, in the central South Island of New Zealand, is rapidly becoming a sporting base of choice for major tournaments and events. On the same day you can mountain bike, snowboard and surf... take your pick! Outdoor pursuits include white water rafting, kayaking, fishing, hunting, horse riding, walking and hiking, mountain biking, sailing, golf, 4 wheel-drive tours. All are plentiful and easily accessible within a short drive from Timaru or any of the smaller town centres within South Canterbury.

## South Canterbury Events

South Canterbury has a very active and continually growing events programme and regularly hosts national events. The Caroline Bay Carnival, the longest running carnival of its type in New Zealand, has been a favourite with families from all over the country since its early days 100 years ago.

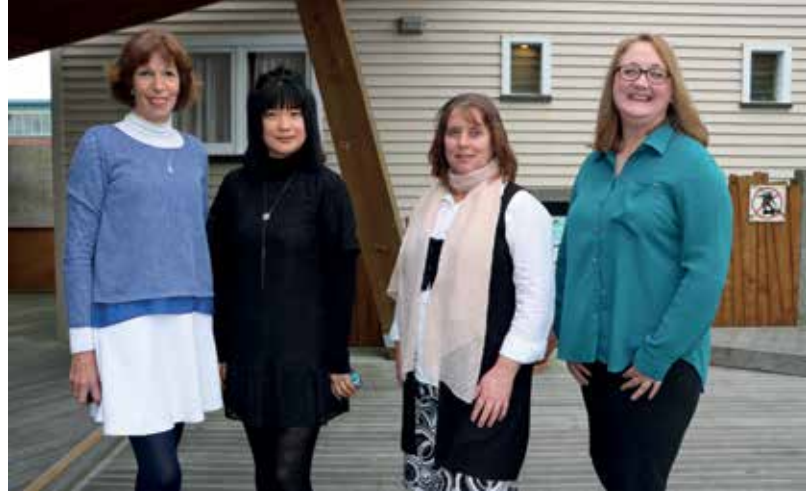

## English tutors and staff

Based in Timaru, from left to right, Stephanie Black, Dan Zhu, Christine Prouting, Angela Wilson

Other major South Canterbury events include the Timaru Festival of Roses, Geraldine Arts & Plants Festival, Waimate Strawberry Fare and motor sport racing at the Timaru International Motor Raceway.

For more detailed information visit:  
[www.southcanterbury.org.nz](http://www.southcanterbury.org.nz)



# English Language

The School of English Language at Ara is internationally recognised as one of the best English language training centres in New Zealand.

NO OF STUDENTS:	<b>up to 300 at any time</b>
CLASS SIZE:	<b>Average 17; maximum 22</b>
LEVELS:	<b>6 levels (beginner to advanced)</b>
MINIMUM AGE:	<b>17 years old, no maximum age</b>

Improve your English	Preparation for Exams	English for Further Study
Intensive English  English Plus courses - Speaking/Listening - Reading/Writing - Volunteer Work - EAP	Full time IELTS Preparation  Full time Cambridge preparation - FCE - CAE	New Zealand Certificate in English Language - Level 1 Foundation - Level 1 - Level 2 - Level 3 (General and Academic) - Level 4 (General and Academic) - Level 5 (Academic)
Minimum 4 weeks up to 50 weeks	Cambridge Intermediate and above      12 weeks	18 weeks
Beginner to Advanced	IELTS Upper Intermediate and above      Min 4 weeks	Level 1 - 5

## Intensive English

### Beginner to Pre Intermediate

You study Intensive English full-time, with a focus on speaking, listening, reading, writing and grammar. We help you to improve your fluency and accuracy, as well as extend your vocabulary. You usually have a different tutor for mornings and afternoons so you will be able to hear different accents.



## Sample Timetable

**Total hours: 22 hours** per week (morning 14 hours + afternoon 8 hours)

**Class hours:** 9am-12:15pm, 1:15-3:15pm

	Monday	Tuesday	Wednesday	Thursday	Friday	Sat/Sun
<b>9am</b>	Starts 9am	Morning English classes			Finishes 11am	Optional weekend activity
		15 min break at 10.30am				
<b>12.15pm</b>	Morning English classes (continued)				Friday afternoon activity	
	Lunch break 12.15 - 1:15pm					
<b>1.15pm</b>	Afternoon English classes					
<b>3.15pm</b>	Optional afternoon activity					

Please note actual timetable may vary.

## English plus Core Skills

### Intermediate level and above

#### • Speaking, Listening and Vocabulary Development

Develop and practise intensive listening skills while improving vocabulary knowledge, using authentic material from TV and radio, as well as textbook and internet-based resource material.

#### • Reading, Writing and Vocabulary Development

Improve reading and writing skills using a wide variety of formal and informal reading texts such as magazines, newspapers and the internet. Develop a range of reading skills such as scanning, skimming and reading for detail. Learn how to plan and write with structure and cohesion.

#### • Grammar and Writing

Improve your grammar through writing with a focus on sentence structure and linking sentences. Build paragraphs and write different kinds of texts.

#### • English for Academic Purposes (EAP)

EAP option focuses on future study courses while improving these core skills.





## Pathways - Intensive English courses

Intensive English courses are open entry. You will be placed in the appropriate level after sitting our placement test

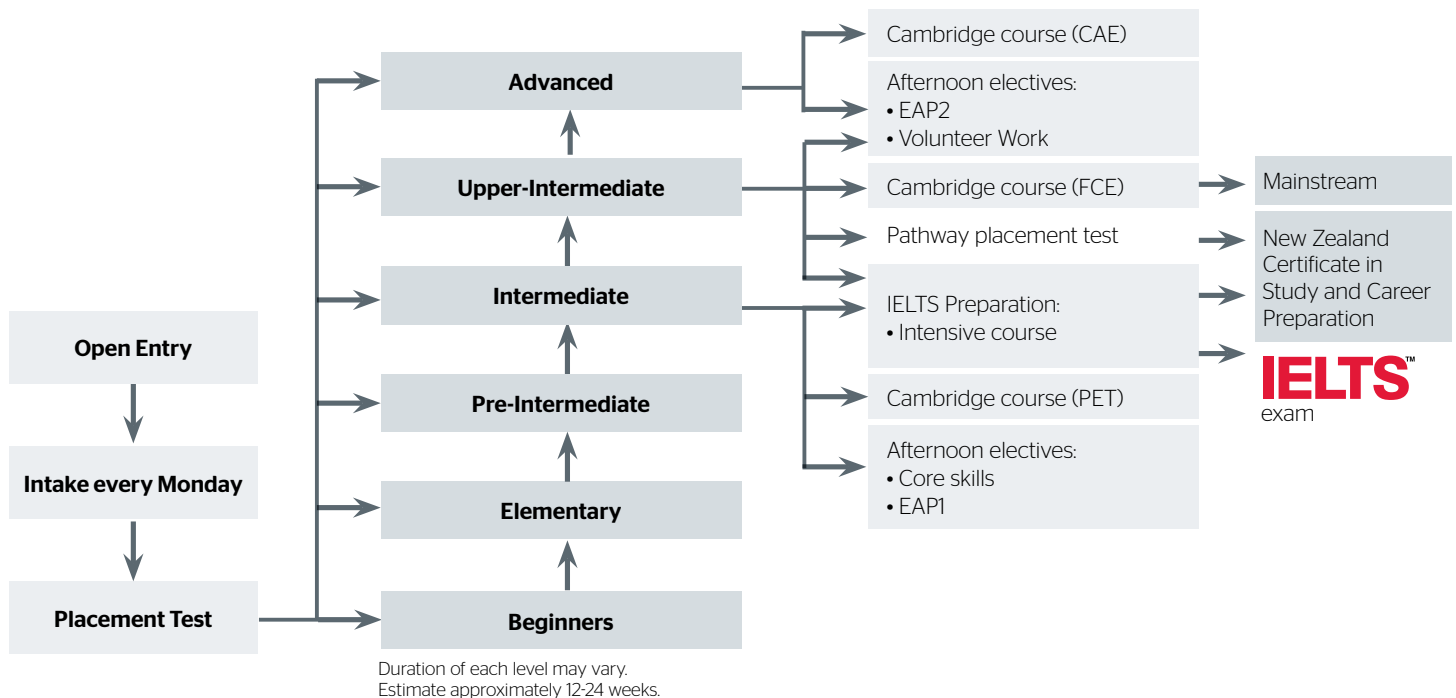

## Short courses

### Speak Better English

This course aims to improve your English conversation skills as well as confidence and fluency. The emphasis is on speaking and listening.

Duration: 18 hours

Christchurch: Saturdays, 10am - 1pm

Oamaru: Thursdays, 9.30am - 11.30am

*This course is not offered in Timaru.*

### Individual Learning Programme

In this course, you will work on an individual programme in our Language Self Access Centre in the library, with help from a tutor. You can prepare for exams such as IELTS or OET, or focus on your reading, writing, speaking, listening, vocabulary or grammar.

In weeks 1, 3 and 5 of each course there will be a one-hour group workshop on IELTS preparation.

Duration: 18 hours

Christchurch: Thursdays, 5pm - 8pm

*This course is not offered in Timaru or Oamaru.*

“The staff are really supportive and always encouraging.”

> **Dannae Garrido (Chile)**  
New Zealand Certificate in English Language



# New Zealand Certificate in English Language (NZCEL)

The New Zealand Certificate in English Language is an NZQA qualification that lasts a lifetime. There are six levels from beginner to advanced. These programmes can be used for further study, for work, or for general English development. They aim to extend your ability in all areas of English communication (speaking, listening, reading and writing), prepare you for further ESOL English or mainstream study, and extend your ability, confidence and comfort in a new country.

The NZCEL is an 18-week course, two blocks of 9 weeks with a two week break in between.

NZCEL can be used to meet English language entry into our mainstream programmes. For further details, refer to the entry criteria of each programme and an equivalence table below. NZCEL is also accepted by the University of Canterbury and Lincoln University.



## Pathways to further study

The following diagram shows various pathways from English language to further academic studies available at Ara. You can start at any point according to your level and our staff will assist you along the way.

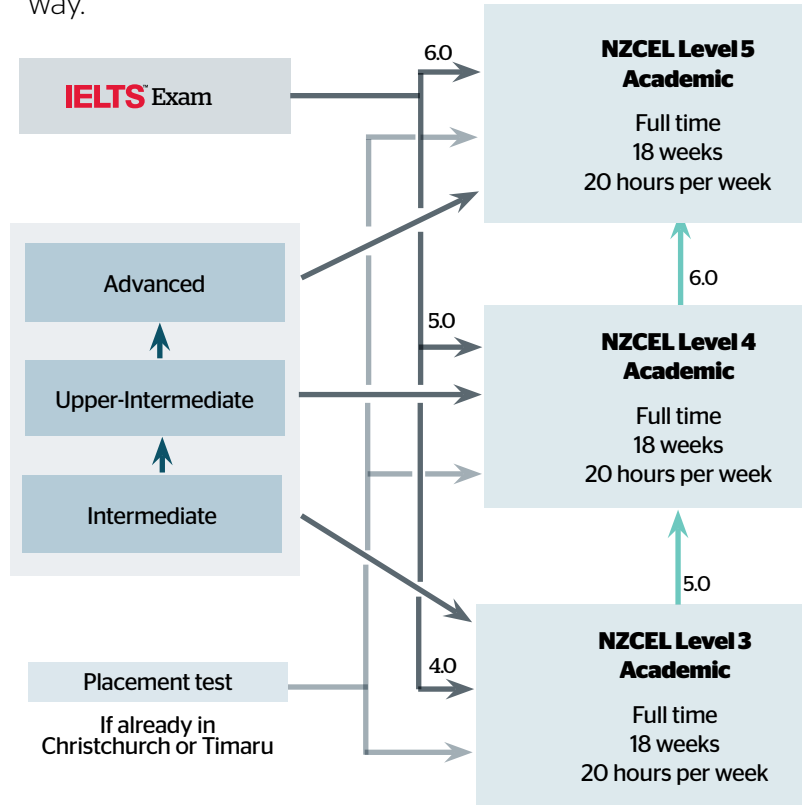

## English Equivalence Table

IELTS		TOEFL PBT		TOEFL iBT		Cambridge			NZCEL		Pearson	OET	City & Guilds
(subtest)		(TWE)		(Writing)		FCE	CAE	CPE	Endorsement				
<b>5</b>	(>5)	<b>500</b>	(>4)	<b>35</b>	(>14)	<b>50</b>	<b>41</b>		<b>Level 3</b>	General Workplace Academic	<b>36</b>		B1 Achiever (>43)
<b>5.5</b>	(>5)	<b>550</b>	(>5)	<b>46</b>	(>14)	<b>Grade C</b>	<b>47</b>		<b>Level 4</b>	General Workplace Academic	<b>42</b>		B2 Communicator (>42)
<b>6</b>	(5.5)	<b>550</b>	(>5)	<b>60</b>	(>18)	<b>Grade B</b>	<b>52</b>		<b>Level 4</b>	Academic	<b>50</b>		B2 Communicator (>66)
<b>6</b>	(>5.5)	<b>570</b>	(>5.5)	<b>70</b>	(>21)	<b>Grade B</b>			<b>Level 4</b>	Academic	<b>54</b>		
<b>6.5</b>	(>6)	<b>590</b>	(>5.5)	<b>79</b>	(>21)	<b>Grade A</b>	<b>58</b>	<b>45</b>	<b>Level 5</b>	Academic Professional	<b>58</b>		C1 Expert (>42)
<b>6.5</b>	(>6.5)	<b>620</b>	(>6)	<b>85</b>	(>22)		<b>62</b>	<b>45</b>	<b>Level 5</b>	Academic Professional	<b>63</b>	<b>Grade C</b>	
<b>7</b>	(>7)	<b>640</b>	(>6)	<b>94</b>	(>24)		<b>Grade A</b>	<b>Grade C</b>	<b>Level 5</b>	Academic Professional	<b>64</b>	<b>Grade B</b>	

Refer to [www.ara.ac.nz/english-equivalence](http://www.ara.ac.nz/english-equivalence) for full details.

If you have achieved NCEA Level 3 University Entrance requirements you are not required to provide evidence of English Language Skills.



## Language Self Access Centre

The Language Self Access Centre (LSAC) at both our Christchurch and Timaru campuses is where you can come to practise and improve your English. We have great resources available at all levels, designed to help you learn at your own pace. Resources available to you include:

- CDs, DVDs and CD-ROMs
- multimedia computer programs
- newspapers, TV news and satellite TV
- course books, worksheet/audio packs, readers and dictionaries
- New Zealand English materials and information about life in this country
- English for specific purposes (e.g. nursing, business, hospitality), English for academic study, IELTS and Cambridge examinations.

As well as English resources, we also have a small selection of materials for students learning Spanish, Japanese and Māori.

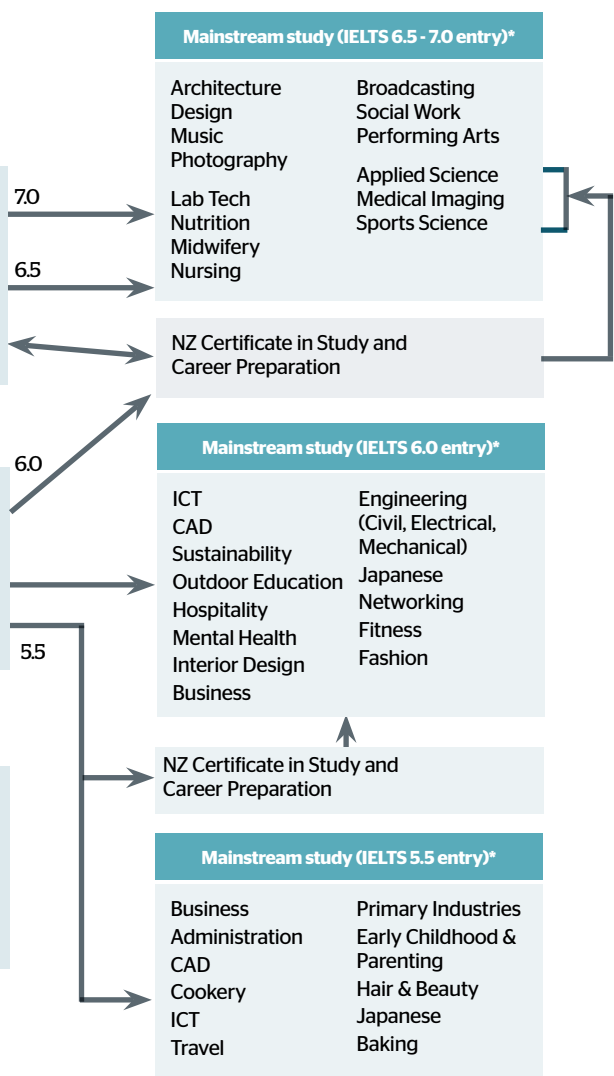

\*Please refer to pages 20-21 for mainstream study options and the programme listings on pages 22-23 for details including IELTS subtest requirements

“ *The ability of mastering language proficiently is the solid foundation for survival and study overseas.* ”

> **Stephanie Dong | China**

NZ Certificate in English Language Level 5 and Graduate Diploma in Sales and Marketing



# Exam Preparation

## Intensive IELTS Preparation

This course will prepare you for taking the IELTS exam by improving your listening, speaking, reading and writing. You can start any Monday, minimum enrolment of 4 weeks.

Our City campus is the largest certified IELTS testing centre in Christchurch.

Dates and times of examinations are published on the following web page:



[www.ara.ac.nz/ielts](http://www.ara.ac.nz/ielts)

## IELTS Exam Preparation Pathways

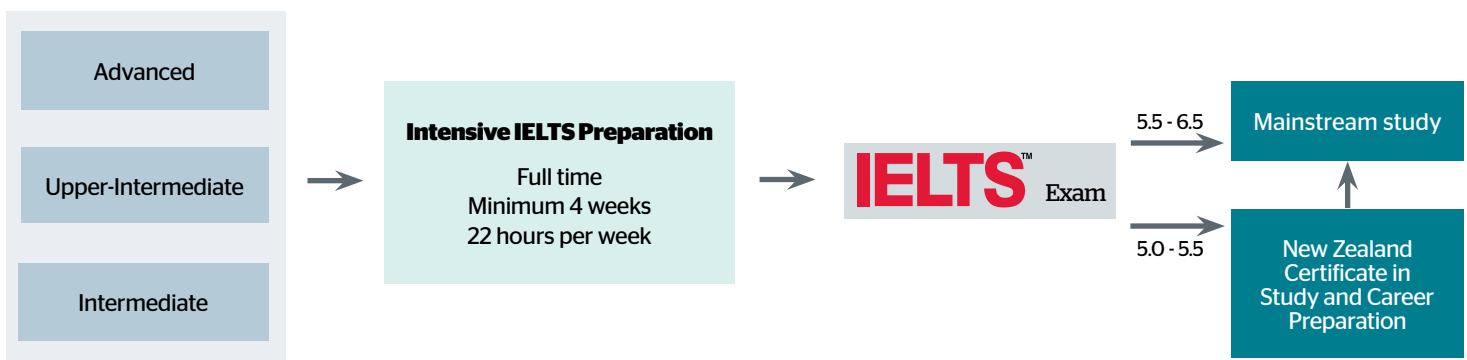

## Examination dates 2018

### IELTS

A & G - Academic and General

Thu: 1 February and 1 November is a Thursday

Month	Exam dates	Module	Month	Exam dates	Module	Month	Exam dates	Module
<b>January</b>	13 January	Academic only	<b>May</b>	5 May	Academic only	<b>September</b>	8 September	A & G
	20 January	A & G		12 May	A & G		29 September	A & G
<b>February</b>	1 February	A & G (Thu)	<b>June</b>	2 June	A & G	<b>October</b>	13 October	A & G
	10 February	A & G		30 June	A & G		27 October	A & G
<b>March</b>	3 March	A & G	<b>July</b>	7 July	A & G	<b>November</b>	1 November	A & G (Thu)
	24 March	A & G		28 July	A & G		10 November	A & G
<b>April</b>	7 April	A & G	<b>August</b>	11 August	Academic only	<b>December</b>	1 December	A & G
	21 April	A & G		18 August	A & G		8 December	A & G



*They have highly skilled and experienced teachers.*



> **Anjana Lama | Nepal**  
IELTS Preparation course



# Cambridge Exam Preparation

**FCE - First Certificate in English**

**CAE - Certificate in Advanced English**

Ara specialises in Cambridge exam preparation. Cambridge certificates are recognised by over 20,000 employers, universities and government ministries as proof of your ability to use English. These certificates never expire, and will not need to be renewed – they are an achievement for life.

Cambridge results can be used to meet English language entry into our mainstream programmes. For further details, refer to the entry criteria of each programme and an equivalence table on page 18.

Dates and fees of examinations are published on the following web page:



[www.ara.ac.nz/cambridge](http://www.ara.ac.nz/cambridge)

## Cambridge Exam Preparation Pathway

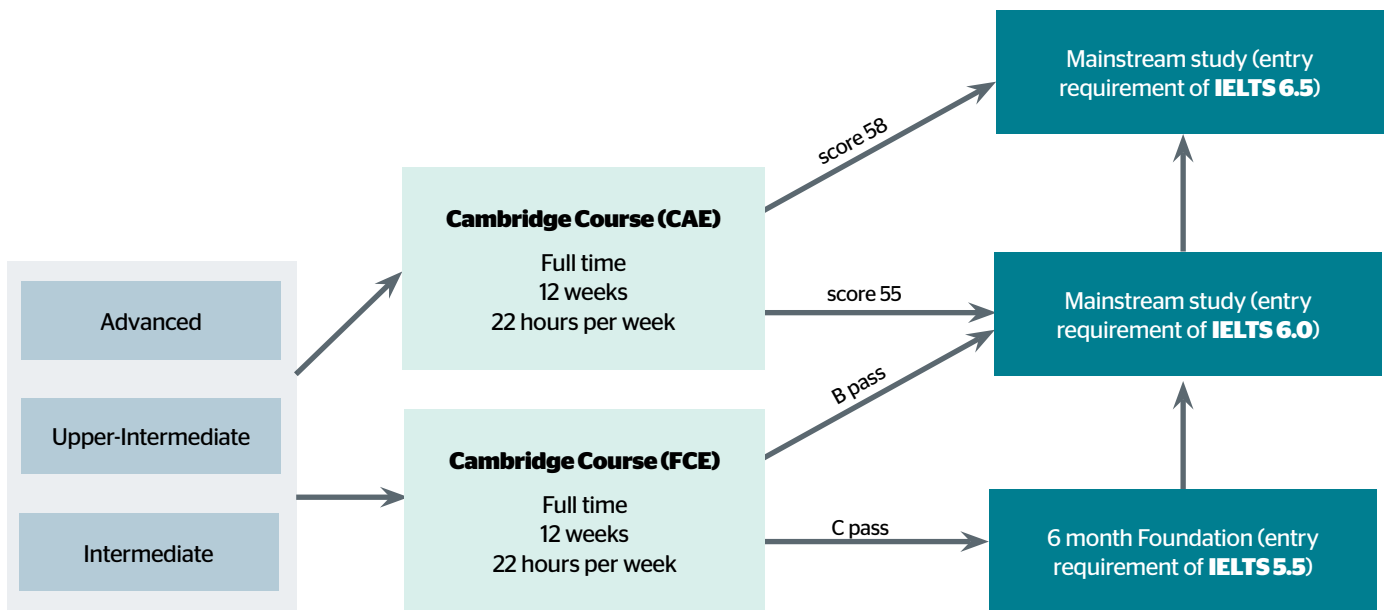

### OET

#### Exam dates

- 13 January
- 11 February
- 10 March
- 14 April
- 19 May
- 16 June
- 14 July
- 11 August
- 9 September
- 6 October
- 3 November
- 2 December

### Cambridge

#### Exam dates

- |     |            |
|-----|------------|
| FCE | 16 March   |
| CAE | 17 March   |
| FCE | 12 June    |
| CAE | 13 June    |
| FCE | 23 August  |
| CAE | 24 August  |
| FCE | 4 December |
| CAE | 5 December |



# Dates and Fees 2018

## English Language courses

Course	Duration	Start Date	Fees
Intensive English English plus Core Skills	4 weeks	<b>Christchurch and Timaru:</b> Every Monday Starts 8 January Finishes 21 December	\$450
Intensive IELTS Exam Preparation (IELTS Exam fee not included)	6 weeks	<b>Christchurch and Timaru:</b> Every Monday Starts 8 January Finishes 21 December	\$675
Cambridge Exam Preparation courses (Exam fee not included)	12 weeks	<b>Christchurch:</b> 8 January - 16 March 19 March - 8 June 5 June - 24 August 10 September - 30 November	\$1,350
NZ Certificate in English Language (NZCEL)	18 weeks	<b>Christchurch and Timaru:</b> 12 February - 29 June 23 July - 7 December  <b>Christchurch additional intake:</b> 24 September - 8 February 2019 (Level 4 Academic only)	\$1,636
Speak Better English	18 hours	<b>Christchurch:</b> 17 February - 24 March 7 April - 12 May 19 May - 30 June 7 July - 11 August 18 August - 22 September 6 October - 24 November  <b>Oamaru:</b> 3 May - 28 June 26 July - 20 September 18 October - 13 December	\$84
IELTS Preparation	18 hours	<b>Oamaru:</b> 3 May - 28 June 26 July - 20 September 18 October - 13 December  <b>Timaru:</b> 19 February to 26 March 9 April to 14 May 21 May to 2 July (no class on public holiday) 9 July to 13 August 20 August to 1 October (no class on public holiday) 8 October to 19 November	\$84
Individual Learning Programme (LP)	18 hours	<b>Christchurch:</b> 22 February - 29 March 5 April - 10 May 17 May - 21 June 28 June - 2 August 9 August - 13 September 20 September - 25 October 1 November - 6 December	\$84

## Public Holidays

New Year Day	Monday 1 January
Day After New Year	Tuesday 2 January
Waitangi Day	Tuesday 6 February
Good Friday	Friday 30 March
Easter Monday	Monday 2 April
Anzac Day	Wednesday 25 April
Queen's Birthday	Monday 4 June
South Canterbury Anniversary Day	Monday 24 September
Labour Day	Monday 22 October
Canterbury Anniversary Day	Friday 16 November
Christmas Day	Tuesday 25 December
Boxing Day	Wednesday 26 December

## Other Important Dates

Ara campus reopens	Wednesday 3 January
Autumn Graduation	Thursday 29 March
Ara closed	Tuesday 3 April
Daylight saving ends	Sunday 1 April
Spring Graduation	Friday 21 September
Daylight saving starts	Sunday 30 September
Ara campus closes	Friday 21 December

## Exam Fees

IELTS exam fee	\$385
Cambridge exam fees (FCE & CAE)	\$310

## Currency Conversion

To convert New Zealand dollar costs to your currency please visit



# Pathway to Foundation/Mainstream

## How to get to the New Zealand Certificate in Study and Career Preparation

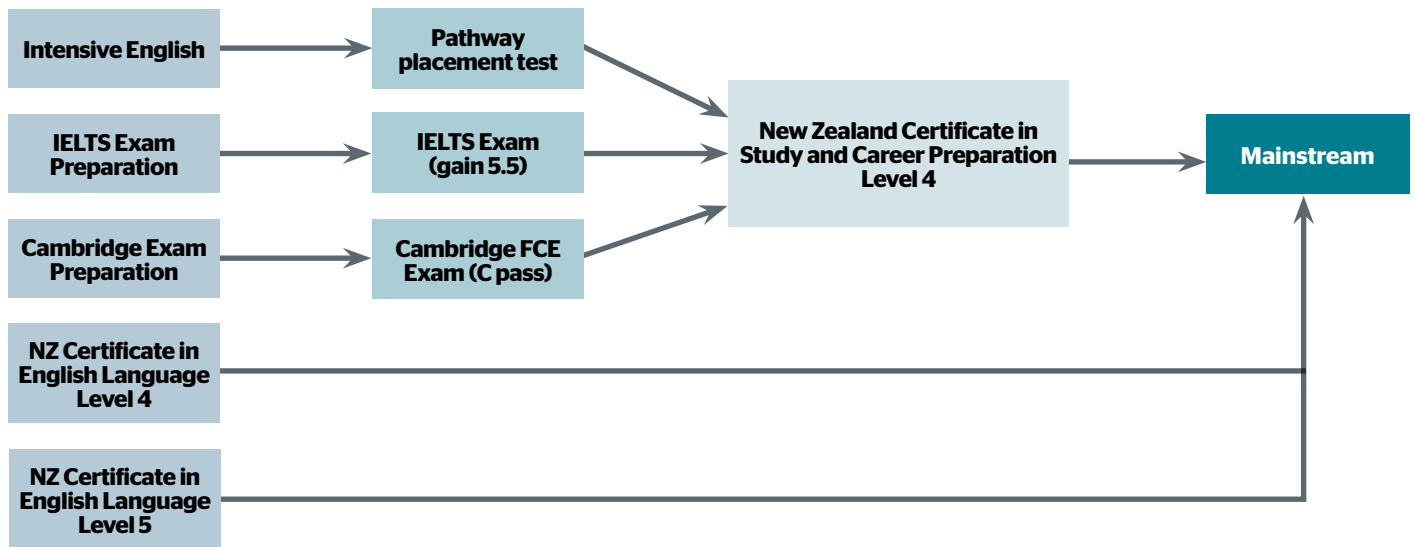

## How to get from the New Zealand Certificate in Study and Career Preparation to mainstream

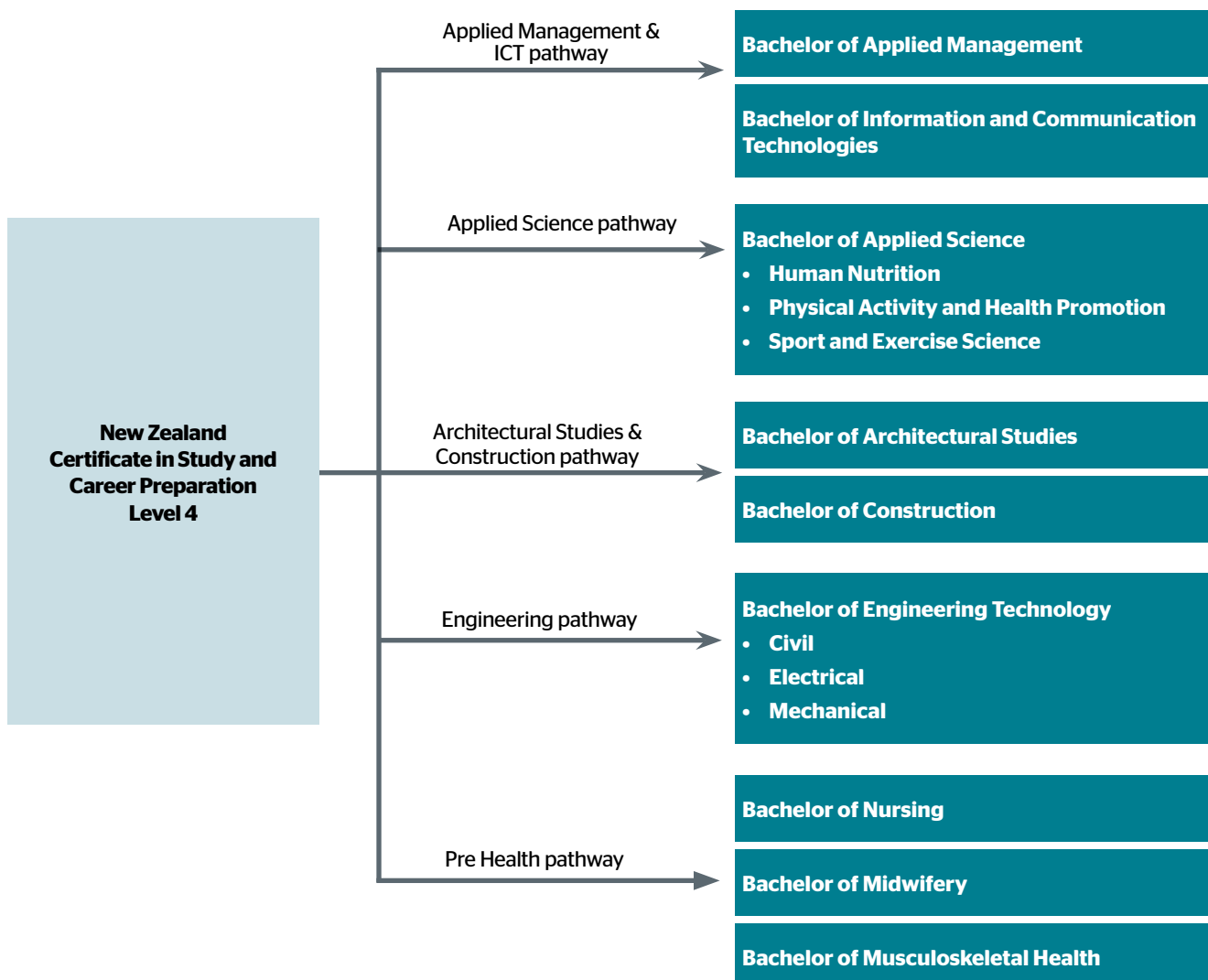

# Further study options

Ara has a range of certificates, diplomas and degrees available for international students.

Legend: ● Certificate / Diploma ● Degree ● Graduate Certificate / Graduate Diploma ● Post Graduate / Masters



## English Language

● Christchurch & Timaru\*  
 Intensive English EAP  
 IELTS Preparation\* Cambridge  
 Volunteer Work CELTA  
 NZ Certificate in English Language (NZCEL)\*



## Foundation Studies

● Christchurch & Timaru\*  
 Study and Career Preparation\*



## Cookery

● Christchurch & Timaru\*  
 Baking and Patisserie\*  
 Professional Cookery\*



## Commerce & Business

● ● ● Christchurch & Timaru\*  
 Accounting\*  
 Applied Business\*  
 Applied Management  
 Business Administration  
 Business Information Systems  
 Event Management  
 Hospitality Management  
 Human Resource Management  
 Marketing and Sales\*  
 Office Management  
 Operations and Production Management  
 Personal Financial Planning  
 Project Management  
 Retail Management  
 Sports Management  
 Strategic Management  
 Supply Chain and Logistics  
 Transformation and Change



## Computing & ICT

● ● ● Christchurch & Timaru\*  
 ICT (Information and Communication Technologies)\*  
 ICT (Information Systems Strategies, Networking, Software Engineering)  
 Computer Networking



## Outdoor Education

● ● ● Christchurch & Timaru\*  
 Environmental and Outdoor Leadership  
 Outdoor Recreation\*  
 Sustainability and Outdoor Education



## Health & Social Services

● ● ● ● Christchurch & Timaru\*  
 Health  
 Medical Imaging  
 Midwifery  
 Musculoskeletal  
 Nursing\*  
 Osteopathy  
 Social Work



## Applied Science

● ● Christchurch  
 Animal Care  
 Animal Management  
 Laboratory Technician  
 Laboratory Technology  
 Quality Systems  
 Veterinary Nursing

Please refer to pages 22-23 for programme listings including IELTS subtests



\*Available in Timaru



## Hospitality

● ● ● Christchurch & Timaru\*

Café Bar Service\*  
Food and Beverage\*  
Hospitality\*  
Hospitality Management



## Travel & Tourism

● ● Christchurch

Travel and Tourism  
International Tourism



## Languages

● ● Christchurch

Japanese  
Māori



## Early Childhood and Parenting

● Christchurch & Timaru\*

Early Childhood Education and Care (pending approval)\*



## Broadcasting

● ● Christchurch

Broadcasting (Radio, Television and Journalism)  
Media Communication



## Performing Arts

● ● Christchurch

Music Arts  
Performing Arts



## Art and Design

● ● ● Christchurch & Timaru\*

Applied Visual Arts\*  
Arts and Media\*  
Content Design and Management  
Digital Design\*  
Digital Media and Design\*  
Fashion Technology  
Photography  
Motion Design  
Visual Communication Design



## Hair and Beauty

● Christchurch & Timaru\*

Beauty Skills\*  
Beauty Therapy\*  
Beauty Therapies and Epilation\*  
Hairdressing\*



## Engineering

● ● ● Christchurch

CAD  
Civil  
Electrical  
Mechanical

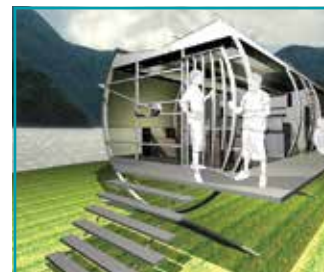

## Architectural Studies

● ● ● ● Christchurch

Architecture  
Construction Management  
Interior Design  
Quantity Surveying



## Sports and Fitness

● ● ● Christchurch

Human Nutrition  
Physical Activity and Health Promotion  
Sport and Exercise Science  
Sports and Fitness



## Primary Industries

● Timaru only

Agribusiness Management  
Production Management

Please refer to pages 22-23 for programme listings including IELTS subtests



# Programme listings

Legend: ● Certificate / Diploma ● Degree ● Graduate Certificate / Graduate Diploma ● Post Graduate / Masters

Qual	Programme	Level	Duration	Commences	Indicative Tuition Fees NZ\$ per year	IELTS	Listening	Reading	Writing	Speaking
<b>FOUNDATION</b>										
C	Study and Career Preparation*	4	6 months	Feb / Jul / Sep	\$9,690	IELTS 5.5	5.5	5.0	5.5	5.0
<b>ARCHITECTURAL STUDIES</b>										
GD	Construction Management	7	1 year	Feb / Jul	\$20,640	IELTS 6.0	5.5	5.5	5.5	5.5
GD	Quantity Surveying	7	1 year	Feb / Jul	\$20,640	IELTS 6.0	5.5	5.5	5.5	5.5
B	Architectural Studies	7	3 years	Feb	\$21,280	IELTS 6.5	6.0	6.0	6.0	6.0
B	Construction (with specialisations in Construction Management and Quantity Surveying)	7	3 years	Feb/Jul	\$20,640	IELTS 6.0	5.5	5.5	5.5	5.5
D	Architectural Technology	6	2 years FT	Feb	\$20,640	IELTS 6.0	6.0	6.0	6.0	6.0
D	Construction (with specialisations in Construction Management and Quantity Surveying)	6	2 years	Feb / Jul	\$20,640	IELTS 6.0	6.0	6.0	6.0	6.0
D	Interior Design (Residential)	5	1 year	Feb	\$21,280	IELTS 6.0	6.0	6.0	6.0	6.0
<b>ART &amp; DESIGN</b>										
M	Arts	9	1 year	Feb	Please enquire	IELTS 6.5	6.0	6.0	6.0	6.0
M	Media Arts	8	1 year	Feb	Please enquire	IELTS 6.5	6.0	6.0	6.0	6.0
GC	Content Design and Management	7	1 year	Jul	Please enquire	IELTS 6.5	6.0	6.0	6.0	6.0
B	Design (with specialisations in Applied Visual Art, Fashion, Motion Design, Photography, and Visual Communication)	7	3 years	Feb	\$21,280	IELTS 6.0	6.0	5.5	5.5	6.0
D	Arts and Media	6	1 year	Feb	\$21,280	IELTS 5.5	5.5	5.5	5.5	5.5
C	Arts and Media	5	1 year	Feb	\$21,280	IELTS 5.5	5.0	5.0	5.0	5.0
C	Digital Design (with specialisations in Digital Design and Photography, and Visual Arts and Design)	5	1 year	Feb	\$21,280	IELTS 5.5	5.0	5.0	5.0	5.0
C	Creativity	4	1 year	Feb / Jul	\$21,280	IELTS 5.5	5.0	5.0	5.0	5.0
C	Digital Media and Design	4	6 months	Feb / Jul	\$21,280	IELTS 5.5	5.0	5.0	5.0	5.0
C	Fashion	4	6 months	Feb / Jul	\$21,280	IELTS 6.0	6.0	6.0	6.0	6.0
<b>BUSINESS</b>										
GD	Accounting	7	1 year	Feb / Jul	\$19,500	IELTS 6.0	6.0	6.0	6.0	6.0
GD	Applied Management	7	1 year	Feb / Jul	\$19,500	IELTS 6.0	6.0	6.0	6.0	6.0
GD	Business Information Systems	7	1 year	Feb / Jul	\$19,500	IELTS 6.0	6.0	6.0	6.0	6.0
GD	Business Transformation & Change	7	1 year	Feb / Jul	\$19,500	IELTS 6.0	6.0	6.0	6.0	6.0
GD	Event Management	7	1 year	Feb	\$19,500	IELTS 6.0	6.0	6.0	6.0	6.0
GD	Hospitality Management	7	1 year	Feb / Jul	\$19,500	IELTS 6.0	6.0	6.0	6.0	6.0
GD	Human Resource Management	7	1 year	Feb / Jul	\$19,500	IELTS 6.0	6.0	6.0	6.0	6.0
GD	Marketing and Sales	7	1 year	Feb / Jul	\$19,500	IELTS 6.0	6.0	6.0	6.0	6.0
GD	Operations & Production Management	7	1 year	Feb / Jul / Oct	\$19,500	IELTS 6.0	6.0	6.0	6.0	6.0
GD	Project Management	7	1 year	Feb / Jul / Oct	\$19,500	IELTS 6.0	6.0	6.0	6.0	6.0
GD	Retail Management	7	1 year	Feb	\$19,500	IELTS 6.0	6.0	6.0	6.0	6.0
GD	Strategic Management	7	1 year	Feb / Jul	\$19,500	IELTS 6.0	6.0	6.0	6.0	6.0
GD	Supply Chain Logistics	7	1 year	Feb / Jul / Oct	\$19,500	IELTS 6.0	6.0	6.0	6.0	6.0
B	Applied Management	7	3 years	Feb / Jul	\$18,770	IELTS 6.0	6.0	6.0	6.0	6.0
C	Business Administration & Technology	4	6 months	Feb / Jul	\$9,385	IELTS 5.0	5.0	5.0	5.0	5.0
C	Business Administration & Technology	3	6 months	Feb / Jul	\$9,385	IELTS 5.0	5.0	5.0	5.0	5.0
<b>COMMUNICATIONS &amp; MEDIA</b>										
B	Broadcasting Communications	7	3 years	Feb	\$22,970	IELTS 6.5	7.0	6.0	6.0	6.0
C	Creativity	4	6 months	Feb / Jul	\$21,280	IELTS 5.5	5.0	5.0	5.0	5.0
<b>COMPUTING &amp; ICT</b>										
GD	Information & Communication Technologies	7	1 year	Feb / Jul	\$20,730	IELTS 6.0	6.0	6.0	6.0	6.0
B	Information & Communication Technologies	7	3 years	Feb / Jul	\$20,020	IELTS 6.0	6.0	6.0	6.0	6.0
D	Networking	6	1 year	Feb / Jul	\$20,020	IELTS 6.0	6.0	6.0	6.0	6.0
D	Systems Administration	6	1 year	Feb / Jul	\$20,020	IELTS 6.0	6.0	6.0	6.0	6.0
D	Web Development and Design	5	1 year	Feb / Jul	\$20,020	IELTS 6.0	6.0	6.0	6.0	6.0
D	Information Technology Technical Support	5	1 year	Feb / Jul	\$20,020	IELTS 6.0	6.0	6.0	6.0	6.0
C	Information Technology Practitioner (with strands)	6	6 months	Feb / Jul	\$6,675	IELTS 5.5	5.5	5.5	5.5	5.5
C	Information Technology Essentials*	4	6 months	Feb / Jul	\$10,010	IELTS 5.5	5.5	5.5	5.5	5.5
<b>ENGINEERING (ELECTRICAL, COMPUTER &amp; DESIGN)</b>										
GD	Computer Aided Design	7	1 year	Feb / Jul	\$20,640	IELTS 6.0	6.0	6.0	6.0	6.0
B	Engineering Technology (Electrical)	7	3 years	Feb	\$21,280	IELTS 6.0	5.5	5.5	6.0	6.0
B	Engineering Technology (Civil)	7	3 years	Feb / Jul	\$21,280	IELTS 6.0	5.5	5.5	6.0	6.0
B	Engineering Technology (Mechanical)	7	3 years	Feb / Jul	\$21,280	IELTS 6.0	5.5	5.5	6.0	6.0
D	Engineering (Electrical)	6	2 years	Feb	\$21,280	IELTS 6.0	5.5	5.5	5.5	5.5
D	Engineering (Civil)	6	2 years	Feb / Jul	\$21,280	IELTS 6.0	5.5	5.5	5.5	5.5
D	Engineering (Mechanical)	6	2 years	Feb / Jul	\$21,280	IELTS 6.0	5.5	5.5	5.5	5.5
D	Computer Aided Design	6	1 year	Feb / Jul	\$20,640	IELTS 6.0	5.5	5.5	5.5	5.5

\*Available in Timaru PT - Part Time FT - Full Time

Qual	Programme	Level	Duration	Commences	Indicative Tuition Fees NZ\$ per year	IELTS	Listening	Reading	Writing	Speaking
<b>EARLY CHILDHOOD</b>										
C	Early Childhood Education and Care	3 & 4	1 year	Feb	Please enquire	IELTS 5.5	5.5	5.5	5.5	5.5
<b>HOSPITALITY &amp; SERVICE INDUSTRIES</b>										
GD	Hospitality Management	7	1 year	Feb / Jul	\$19,500	IELTS 6.0	6.0	6.0	6.0	6.0
B	International Tourism and Hospitality Management	7	3 years	Feb / Jul	\$20,020	IELTS 6.0	5.5	5.5	5.5	5.5
D	Hospitality Management	6   5	2 years	Feb / Jul	\$20,020	IELTS 5.5	5.0	5.0	5.0	5.0
D	Cookery (Advanced) - Cookery Strand*	5   4	2 years	Feb / Jul	\$20,020	IELTS 5.5	5.5	5.5	5.5	5.5
D	Cookery (Advanced) - Patisserie Strand*	5   4	2 years	Feb / Jul	\$20,020	IELTS 5.5	5.5	5.5	5.5	5.5
C	Baking (Generalist) (Career Baker)*	4	1 year	Feb	\$20,020	IELTS 5.5	5.0	5.0	5.0	5.0
C	Food & Beverage Service*	3 & 4	1 year	Feb	\$20,020	IELTS 5.5	5.5	5.5	5.5	5.5
C	Tourism & Travel	3 & 4	1 year	Feb	\$20,020	IELTS 5.5	5.5	5.5	5.5	5.5
<b>HAIR &amp; BEAUTY</b>										
D	Beauty Therapies and Epilation*	5	1 year	Feb	\$20,020	IELTS 5.5	5.0	5.0	5.0	5.0
C	Beauty Therapy*	4	1 year	Feb	\$20,020	IELTS 5.5	5.0	5.0	5.0	5.0
C	Hairdressing (Emerging Stylist)*	4	1 year	Feb	\$20,020	IELTS 5.0	5.0	5.0	5.0	5.0
C	Hairdressing (Salon Support)*	3	1 year	Feb	\$20,020	IELTS 5.0	5.0	5.0	5.0	5.0
<b>HEALTH</b>										
M	Health Science	9	15 years	Feb / Jul	\$21,710	IELTS 6.5	6.5	6.5	6.5	6.5
M	Nursing	9	2 years	Feb / Jul	\$21,710	IELTS 6.5	6.5	6.5	6.5	6.5
PG	Health Science	8	1 year	Feb / Jul	\$21,710	IELTS 6.5	6.0	6.0	6.0	6.0
PG	Health Science	8	6 months	Feb / Jul	\$10,855	IELTS 6.5	6.0	6.0	6.0	6.0
PG	Nursing	8	1 year	Feb	\$21,710	IELTS 6.5	7.0	6.5	6.5	6.5
GD	Health	7	1 year	Feb / Jul	\$21,710	IELTS 6.5	7.0	6.5	6.5	6.5
GD	Nursing	7	1 year	Feb / Jul	\$21,710	IELTS 7.0	7.0	7.0	7.0	7.0
B	Medical Imaging	7	3 years	Feb	\$21,760	IELTS 6.5	7.0	6.5	6.5	7.0
B	Midwifery	7	3 years	Jan	\$28,900	IELTS 7.0	7.0	6.5	6.5	7.0
B	Nursing*	7	3 years	Feb / Jul	\$21,710	IELTS 6.5	7.0	6.5	6.5	6.5
B	Nursing (articulated with University of Canterbury Master of Health Science)	7	2 years	Feb	Please enquire	IELTS 6.5	7.0	6.5	6.5	6.5
B	Social Work	7	4 years	Feb	\$21,710	IELTS 6.5	6.5	6.5	6.5	6.5
D	Enrolled Nursing	5	15 years	Mar	\$21,280	IELTS 6.5	6.5	6.5	6.5	6.5
<b>INTERNATIONAL LANGUAGES</b>										
B	Language (Japanese)	7	3 years	Feb	\$20,020	IELTS 6.0	6.0	6.0	6.0	6.0
C	Japanese	4	1 year	Feb	\$20,020	IELTS 5.5	5.0	5.0	5.0	5.0
C	Japanese (Foundation)	3	6 months	Feb	\$10,010	IELTS 5.0	5.0	5.0	5.0	5.0
<b>OUTDOOR EDUCATION</b>										
GD	Sustainability and Outdoor Education	7	1 year	Feb / Jul	\$21,280	IELTS 6.0	6.0	6.0	6.0	6.0
GC	Environmental and Outdoor Leadership	7	6 months	Feb	\$10,640	IELTS 6.0	6.0	6.0	6.0	6.0
B	Sustainability and Outdoor Education	7	3 years	Feb / Jul	\$21,280	IELTS 6.0	6.0	6.0	6.0	6.0
D	Environmental and Outdoor Leadership	5	1 year	Feb / Jul	\$21,280	IELTS 6.0	6.0	6.0	6.0	6.0
C	Outdoor Recreation	4	34 weeks	Feb	\$21,280	IELTS 5.5	5.5	5.5	5.5	5.5
<b>PERFORMANCE</b>										
B	Music Arts	7	3 years	Feb	\$20,640	IELTS 6.0	5.5	5.5	5.5	5.5
B	Performing Arts (Music Theatre)	7	3 years	Feb	\$20,640	IELTS 6.5	6.5	6.5	6.5	6.5
C	Contemporary Music Performance	4	1 year	Feb	\$20,640	IELTS 5.5	5.0	5.0	5.0	5.0
<b>PRIMARY INDUSTRIES</b>										
D	Agribusiness Management*	5	1 year	Feb	Please enquire	IELTS 5.5	5.0	5.0	5.0	5.0
C	Primary Industry Production Management (Livestock Production)*	5	23 weeks	Mar	Please enquire	IELTS 5.5	5.0	5.0	5.0	5.0
<b>SCIENCE</b>										
GD	Human Nutrition	7	1 year	Feb	\$21,700	IELTS 6.5	7.0	6.0	6.0	7.0
GD	Laboratory Technology	7	1 year	Feb / Jul	\$21,700	IELTS 6.5	7.0	6.0	6.0	7.0
GD	Physical Activity, Health and Wellness	7	1 year	Feb	\$21,700	IELTS 6.5	7.0	6.0	6.0	7.0
GD	Sport & Exercise Science	7	1 year	Feb	\$21,700	IELTS 6.5	7.0	6.0	6.0	7.0
B	Applied Science	7	3 years	Feb	\$21,700	IELTS 6.5	7.0	6.0	6.0	7.0
D	Applied Science	6	1 year	Feb / Jul	\$19,380	IELTS 6.0	6.0	6.0	6.0	6.0
D	Applied Science	5	1 year	Feb / Jul	\$19,380	IELTS 6.0	6.0	6.0	6.0	6.0
D	Veterinary Nursing	6	1 year	Feb	\$19,380	IELTS 6.0	6.5	6.5	6.0	6.0
C	Animal Technology (with Veterinary Nursing Assistant strand)	5	1 year	Feb	\$19,380	IELTS 6.0	6.5	6.5	6.0	6.0
C	Fitness	5	6 months	Feb / Jul	\$10,620	IELTS 6.0	6.5	5.0	5.0	6.5
C	Animal Management with Companion Animal strand	4	1 year	Feb	\$19,380	IELTS 5.5	5.0	5.0	5.0	5.0



Institute of Canterbury

Ara rau, taumata rau

### Code of Practice Requirements

Ara has agreed to observe and be bound by the Education (Pastoral Care of International Students) Code of Practice 2016 administered by the New Zealand Qualifications Authority (NZQA). Copies of the Code are available on request from this institution or from the NZQA website at: [www.nzqa.govt.nz/providers-partners/education-code-of-practice/](http://www.nzqa.govt.nz/providers-partners/education-code-of-practice/)

### Immigration

Full details of visa and permit requirements, advice on rights to employment in New Zealand while studying and reporting requirements are available through the New Zealand Immigration Service and can be viewed at: [www.immigration.govt.nz](http://www.immigration.govt.nz)

### Eligibility for Health Services

Most international students are not entitled to publicly funded health services while in New Zealand. If you receive medical treatment during your visit, you may be liable for the full costs of that treatment. Full details on entitlements to publicly funded health services are available through the Ministry of Health, and can be viewed at: [www.moh.govt.nz](http://www.moh.govt.nz)

### Accident Insurance

The Accident Compensation Corporation provides accident insurance for all New Zealand citizens, residents, and temporary visitors to New Zealand, but you may still be liable for all other medical and related costs. Further information can be viewed on the ACC website at: [www.acc.co.nz](http://www.acc.co.nz)

### Medical Insurance

Ara requires all international students to have comprehensive travel and medical insurance. This is a legal requirement under the New Zealand Ministry of Education Code of Practice for the Pastoral Care of International Students. The preferred insurance provider for Ara is Allianz StudentPlus, which has specifically tailored its policy to meet the needs of our students. More information can be found at: [www.ara.ac.nz/insurance](http://www.ara.ac.nz/insurance)

Ara is proud to be a smokefree institute

---

**PO Box 540, Christchurch 8140, New Zealand**

**Telephone +64 3 940 8389**

**[www.ara.ac.nz](http://www.ara.ac.nz)**

---

## We want to keep in touch:



[schoolofenglish@ara.ac.nz](mailto:schoolofenglish@ara.ac.nz)



+64 3 940 8389



[www.ara.ac.nz/international](http://www.ara.ac.nz/international)



[www.facebook.com/AraInternational](https://www.facebook.com/AraInternational)



[www.youtube.com/AraCanterbury](https://www.youtube.com/AraCanterbury)



[www.twitter.com/AraCanterbury](https://www.twitter.com/AraCanterbury)



[www.instagram.com/myara](https://www.instagram.com/myara)



AraCanterbury